

Explosion-Proof Pilot Devices

Nema Type 4, 4X, 7 & 9

Momentary Contact Pushbuttons

Specifications

XPBS - FGC A - FS (-CEN)
a b c d e f g ATEX Optional

a = Push Button Heads

| Code | Description |
|-------------------------------|-----------------------------------|
| B | Standard Push Button Head |
| MH (red or green button only) | **Standard Mushroom Head-Metal |
| JMH (red button only) | **Jumbo Mushroom Head-Metal |
| JMHE (white print/red head) | **Jumbo "Emergency Stop" Engraved |

b = Barrel Type

| Code | Description |
|------|--------------|
| S | Short Barrel |
| L | Long Barrel |

c = Operator Type

| Code | Description |
|------|---------------|
| E | Extended Head |
| F | Flush Head |
| R | For MH / JMH |

d = Button Color

| Code | Description |
|------|-------------|
| B | Black |
| BU | Blue |
| G | Green |
| R | Red |
| Y | Yellow |

*Note: Does not apply for Jumbo

e = Rubber Boot

| Code | Description |
|--------|---------------------------|
| XPB-B | PB Black Boot with Guard |
| XPB-G | PB Green Boot with Guard |
| XPB-R | PB Red Boot with Guard |
| XPB-BU | PB Blue Boot with Guard |
| XPB-Y | PB Yellow Boot with Guard |

*Note: This option replaces options C & D



Extended Pushbutton
XPBS-ERC

Flush Pushbutton
XPBS-FGC

f = Contact Blocks

| Code | Description |
|-------|------------------------|
| Blank | No Contacts |
| A | 1 N.O. |
| B | 1 N.C. |
| 2A | 2 N.O. |
| 2B | 2 N.C. |
| C | 1 N.O. / 1 N.C. |
| *D | 2 N.O. / 2 N.C. |
| E | 1 N.C.L.B. |
| F | 1 N.O.E.M. |
| 2E | 2 N.C.L.B. |
| 2F | 2 N.O.E.M. |
| *G | 1 N.O. / 1 N.C.L.B. |
| *H | 1 N.C. / 1 N.C.L.B. |
| *J | 3 N.O. / 3 N.C. |
| *K | 4 N.O. / 4 N.C. |
| L | N.O.E.M.-N.C. |
| M | N.O.E.M.-N.O. |
| N | N.C.L.B.-N.O.E.M. |
| P | 2 N.O. / 2 N.C. (300V) |

g = Accessories

| Code | Description |
|------|--------------------|
| -FS | Finger Safe Option |

CONTACT ABBREVIATION

N.O.= Normally Open
N.C.= Normally Closed
N.C.L.B.= Normally Closed- Late Break
N.O.E.M.= Normally Open- Early Make

All contact blocks are rated 600V unless noted.

N4= NEMA 4 locking collar is standard on all Akron Electric operators

3/4"-14 NPSM standard thread

Pushbuttons can also be used with Allen Bradley or C3 Controls contact blocks. (C/F)

*Denotes multiple block configuration

**Mushroom heads are made of Anodized Aluminum (Green or Red Only). Jumbo comes in Red only.



Explosion-Proof Pilot Devices

Nema Type 4, 4X, 7 & 9

XP PUSHBUTTON OPERATORS DIMENSIONAL DATA

Dimensions (Inches [mm])

Note: All dimensions are for reference only

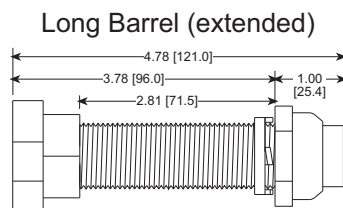

Long Barrel (extended)

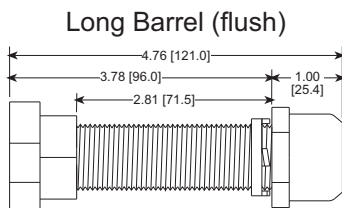

Long Barrel (flush)

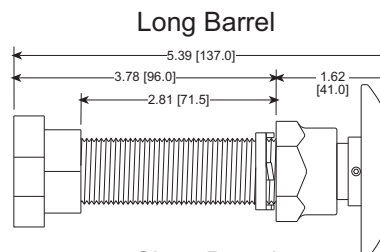

Long Barrel

Short Barrel (extended)

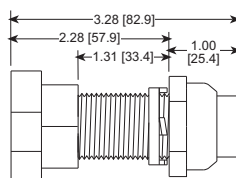

Short Barrel (flush)

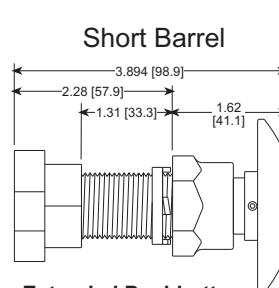
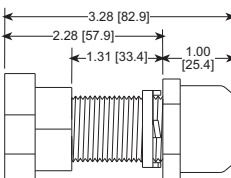

Short Barrel

Extended Pushbutton
ex. XPBS-ER

Extended Pushbutton
ex. XPBS-FG

Extended Pushbutton
ex. XPJMHS-RA

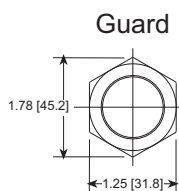

Guard

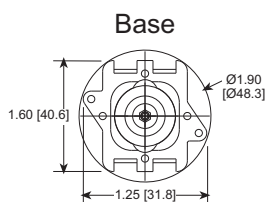

Base

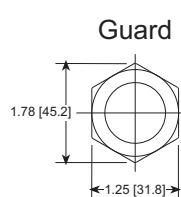

Guard

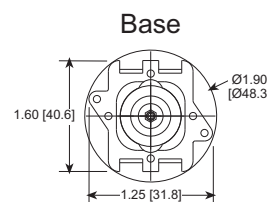

Base

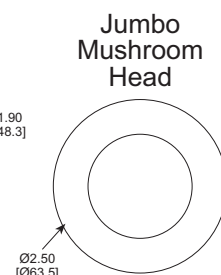

Jumbo
Mushroom
Head



LR86146



FILE NO. E203605
FILE NO. E139669
FILE NO. E181300



(Optional)

Features

- Operator bodies are black anodized & teflon-impregnated.
- Operator shafts are stainless steel.
- 3/4-14 NPSM threaded body size.
- Explosion-proof operators are suitable for panel or surface mount applications
- **Long Series:** accommodates up to 2-1/2" thick enclosure wall thickness
- **Short Series:** accommodates up to 1" thick enclosure wall thickness
- Momentary pushbuttons are available in flush and extended versions.
- Momentary pushbuttons are molded thermoplastic protected by a machined aluminum guard.

**CLASS I, Div 1 & 2, GROUPS B, C & D;
CLASS II, Div 1 & 2, GROUPS E, F & G;
CLASS III;
NEMA TYPE 4, 4X, 7 & 9**

UL 698 Industrial Control Equipment for use in hazardous (Classified) locations.

UL 1203 Explosion-Proof and Dust-Ignition Proof Electrical Equipment for use in hazardous (Classified) locations.

CSA C22.2 No. 30-LR86146 Explosion-Proof Enclosures for use in Class I Hazardous locations.

Explosion-Proof Pilot Devices

Nema Type 4, 4X, 7 & 9

2 & 3 Position Push-Pull Switch Operators

Specifications



2 Position Push-Pull
Switch Operator
XPPPS-2GE

XPPP S - 2 RA - FS (-CEN)
a b c d e f ATEX Optional

a = Barrel Type

| Code | Description |
|------|--------------|
| S | Short Barrel |
| L | Long Barrel |

b = Number of Positions

| Code | Description |
|------|-------------|
| 2 | 2-Position |
| 3 | 3-Position |

c = **Mushroom Heads

| Code | Description |
|-------|------------------------|
| Blank | Standard Mushroom Head |
| J | Jumbo Mushroom Head |

Note: To engrave mushroom heads, C/F

d = Button Color

| Code | Description |
|------|-------------|
| G | Green |
| R | Red |

e = Contact Blocks

| Code | Description |
|-------|------------------------|
| Blank | No Contacts |
| A | 1 N.O. |
| B | 1 N.C. |
| 2A | 2 N.O. |
| 2B | 2 N.C. |
| C | 1 N.O. / 1 N.C. |
| *D | 2 N.O. / 2 N.C. |
| E | 1 N.C.L.B. |
| F | 1 N.O.E.M. |
| 2E | 2 N.C.L.B. |
| 2F | 2 N.O.E.M. |
| *G | 1 N.O. / 1 N.C.L.B. |
| *H | 1 N.C. / 1 N.C.L.B. |
| *J | 3 N.O. / 3 N.C. |
| *K | 4 N.O. / 4 N.C. |
| L | N.O.E.M.-N.C. |
| M | N.O.E.M.-N.O. |
| N | N.C.L.B.-N.O.E.M. |
| P | 2 N.O. / 2 N.C. (300V) |

f = Accessories

| Code | Description |
|------|--------------------|
| -FS | Finger Safe Option |

CONTACT ABBREVIATION

N.O.= Normally Open
N.C.= Normally Closed
N.C.L.B.= Normally Closed- Late Break
N.O.E.M.= Normally Open- Early Make
E.C.N.O.= Early Close-Normally Open
L.O.N.C.= Late Open-Normally Closed

All contact blocks are rated 600V
unless noted.

N4= NEMA 4 locking collar is standard
on all Akron Electric operators

3/4"-14 NPSM standard thread

Pushbuttons can also be used with
Allen Bradley or C3 Controls
contact blocks. (C/F)

*Denotes multiple block configuration

**Mushroom heads are made of
Anodized Aluminum



Explosion-Proof Pilot Devices

Nema Type 4, 4X, 7 & 9

XP 2 & 3 Position Push-Pull Operators Dimensional Data

Dimensions (Inches [mm])

Note: All dimensions are for reference only



LR86146



FILE NO. E203605
FILE NO. E139669
FILE NO. E181300



(Optional)

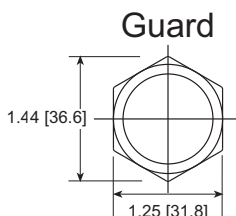
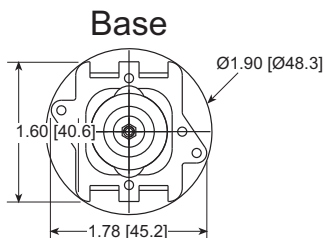

Mushroom Head Cap

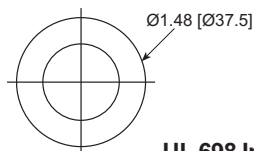

Short Barrel

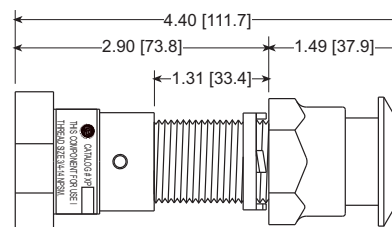

Long Barrel

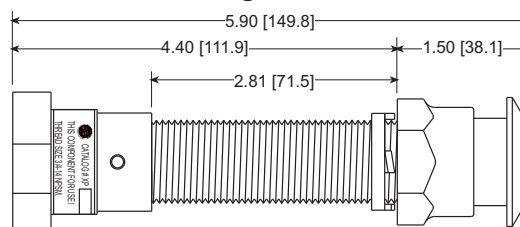

Push-Pull Operator
ex. XPPPL-2JR

CLASS I, Div 1 & 2, GROUPS B, C & D;
CLASS II, Div 1 & 2, GROUPS E, F & G;
CLASS III,
NEMA TYPE 4, 4X, 7 & 9

UL 698 Industrial Control Equipment in Hazardous (Classified) Locations.

UL 1203 Explosion-Proof and Dust-Ignition-Proof Electrical Equipment for Use in Hazardous (Classified) Locations.

CSA C22.2 No. 30-LR86146 Explosion-Proof Enclosures for use in Class I Hazardous locations.

FEATURES

- Operator bodies are black anodized & teflon impregnated.
- Operating Shafts are stainless steel.
- 3/4-14 NPSM threaded body size
- **Long Series:** Accommodates up to 2-1/2" thick enclosure wall thickness.
- **Short Series:** Accommodates up to 1" thick enclosure wall thickness.
- Explosion-Proof Operators are suitable for panel or surface mount applications.
- See Contact Block Information sheet for mounting and rating information.
- Mushroom Push Buttons are 1-1/2" Diameter Aluminum
- Jumbo 2-1/2" Dia. Aluminum Red Mushroom Button available
- Push-Pull Operator available 2 or 3 position

Explosion-Proof Pilot Devices

Nema Type 4, 4X, 7 & 9

Dual Pushbuttons (Momentary)

Specifications

XPDB S - FGERCH0 - FS (-CEN)
a b c d e f ATEX Optional

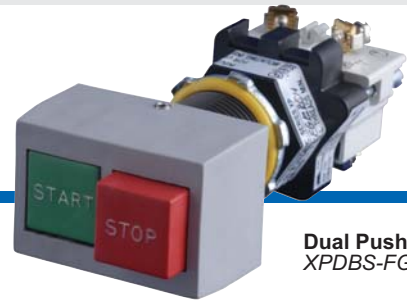

Dual Pushbutton
XPDBS-FGERCH1

a = Barrel Type

| Code | Description |
|------|--------------|
| L | Long Barrel |
| S | Short Barrel |

b = Button Sequence & Color

| Code | Description |
|------|-------------------------------|
| FGER | Flush (Green), Extended (Red) |
| FBFB | Flush (Black), Flush (Black) |

*Note - C/F for alternate combinations

d = Mounting

| Code | Description |
|------|-------------|
| H | Horizontal |
| V | Vertical |

e = Marking & Position

| Code | Top or Left Side | Bottom or Right Side |
|------|------------------|----------------------|
| 0 | BLANK | BLANK |
| 1 | START | STOP |
| 2 | ON | OFF |
| 3 | OPEN | CLOSE |
| 4 | UP | DOWN |
| 5 | FWD | REV |

c = Contact Blocks

| Code | Description |
|-------|------------------------|
| Blank | No Contacts |
| 2A | 2 N.O. |
| 2B | 2 N.C. |
| C | 1 N.O. / 1 N.C. |
| *D | 2 N.O. / 2 N.C. |
| 2E | 2 N.C.L.B. |
| 2F | 2 N.O.E.M. |
| *G | 1 N.O. / 1 N.C.L.B. |
| *H | 1 N.C. / 1 N.C.L.B. |
| *J | 3 N.O. / 3 N.C. |
| *K | 4 N.O. / 4 N.C. |
| L | N.O.E.M.-N.C. |
| M | N.O.E.M.-N.O. |
| N | N.C.L.B.-N.O.E.M. |
| P | 2 N.O. / 2 N.C. (300V) |

f = Accessories

| Code | Description |
|------|--------------------|
| -FS | Finger Safe Option |

CONTACT ABBREVIATION

N.O.= Normally Open
N.C.= Normally Closed
N.C.L.B.= Normally Closed- Late Break
N.O.E.M.= Normally Open- Early Make

Pushbuttons can also be used with
Allen Bradley or C3 Controls
contact blocks. (C/F)

*Denotes multiple block configuration

All contact blocks are rated 600V
unless noted.

N4= NEMA 4 locking collar is standard
on all Akron Electric operators

3/4"-14 NPSM standard thread



Explosion-Proof Pilot Devices

Nema Type 4, 4X, 7 & 9

XP Dual Push Button Operators Dimensional Data

Dimensions (Inches [mm])

Note: All dimensions are for reference only



LR86146



FILE NO. E203605
FILE NO. E139669
FILE NO. E181300



(Optional)

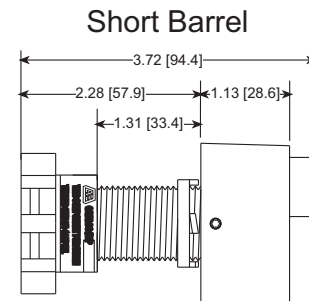
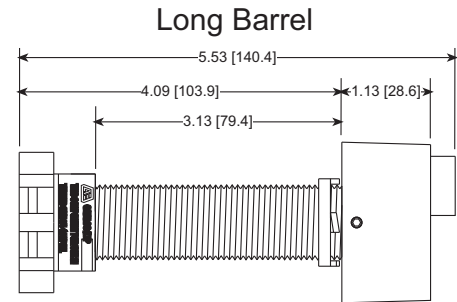
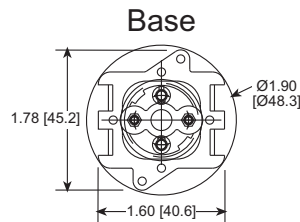
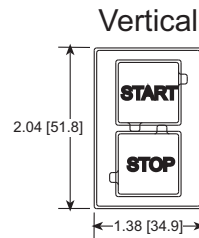
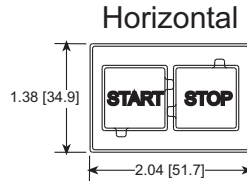

Dual Push Button
ex. XPDBS-FGERC

CLASS I, Div 1 & 2, GROUPS B, C & D;
CLASS II, Div 1 & 2, GROUPS E, F & G;
CLASS III,
NEMA TYPE 4, 4X, 7 & 9

UL 698 Industrial Control Equipment in Hazardous (Classified) Locations.

UL 1203 Explosion-Proof and Dust-Ignition-Proof Electrical Equipment for Use in Hazardous (Classified) Locations.

CSA C22.2 No. 30-LR86146 Explosion-Proof Enclosures for use in Class I Hazardous locations.

FEATURES

- Operator bodies are black anodized & teflon impregnated.
- Operating Shafts are stainless steel.
- 3/4-14 NPSM threaded body size
- **Long Series:** Accommodates up to 2-1/2" thick enclosure wall thickness.
- **Short Series:** Accommodates up to 1" thick enclosure wall thickness.
- Explosion-Proof Operators are suitable for panel or surface mount applications.
- See Contact Block Information sheet for mounting and rating information.
- Dual Push Button Operators are available in horizontal or vertical button configuration.
- Dual Push Button Operators are available blank or with standard lettering.
- For Custom Engraving, Consult Factory

